

Licensing/Gambling Hearing

To: Councillors Galvin, Looker and Wann

Date: Monday, 11 July 2022

Time: 10.00 am

Venue: Remote Meeting

A G E N D A

1. Chair

To elect a Member to act as Chair of the meeting.

2. Introductions

3. Declarations of Interest

At this point in the meeting, Members are asked to declare any disclosable pecuniary interest or other registerable interest they might have in respect of business on this agenda, if they have not already done so in advance on the Register of Interests.

4. Exclusion of Press and Public

To consider excluding the Press and Public during the sub-committee's deliberations and decision-making at the end of the hearing, on the grounds that the public interest in excluding the public outweighs the public interest in that part of the meeting taking place in public, under Regulation 14 of the Licensing Act 2003 (Hearings) Regulations 2005.

5. Minutes (pages 7 – 13)

To approve the minutes of the Licensing Hearing held on 13 June 2022.

6. The Determination of a Section 18(3)(a) Application by Bad Habits Coffee Bar Limited for a Premises Licence in respect of The Old Butcher's Coffee Shop, 16a York Street, Dunnington, York YO19 5PN (CYC-070776) (pages 15 – 63)

Democratic Services officer:

Name: Fiona Young

Contact Details:

- Telephone – (01904) 552030
- Email - fiona.young@york.gov.uk

For more information about any of the following, please contact the Democratic Services officer responsible for servicing this meeting:

- Business of the meeting
- Any special arrangements
- Copies of reports and
- For receiving reports in other formats.

Contact details are set out above.

This information can be provided in your own language.

我們也用您們的語言提供這個信息 (Cantonese)

এই তথ্য আপনার নিজের ভাষায় দেয়া যেতে পারে। (Bengali)

Ta informacja może być dostarczona w twoim własnym języku. (Polish)

Bu bilgiyi kendi dilinizde almanız mümkündür. (Turkish)

یہ معلومات آپ کی اپنی زبان (بولی) میں بھی مہیا کی جاسکتی ہیں۔ (Urdu)

☎ (01904) 551550

LICENSING ACT 2003 SUB – COMMITTEES PROCEDURE FOR REMOTE LICENSING HEARINGS

Introduction

1. During the coronavirus pandemic emergency period it will be necessary for licensing hearings to be dealt with remotely. This procedure sets out how City of York Council will deal with such hearings. This procedure must be considered in conjunction with the Council's Delivery of Remote Meetings document which sets out how all meetings, including licensing hearings will be held in York.
2. The procedure adopted at a licensing hearing is at the discretion of the Sub-Committee but will normally follow the pattern outlined below.
3. The Council's hearings procedure is based on regulations made by the Secretary of State under the Licensing Act 2003. The procedure is intended as a general framework to ensure natural justice and a fair hearing. The Sub-Committee has a duty to view all evidence presented before them impartially. The Sub-Committee is not bound by the formal rules of evidence. Nevertheless, Members must carry out their duty placing what weight they feel is appropriate given the nature of the evidence and the manner in which it was obtained, and communicated.
4. The Council will provide a record of the hearing in a permanent and intelligible form and keep it for 6 years from the date of determination or disposal of any Appeal. The Hearing will be recorded and the recording placed on the Council's website.

Preparation for the Remote Licensing Hearing

5. The Sub-Committee will use the video-conferencing platform when the hearing is in public session. Clear instructions will be provided to participants on how to join the remote hearing. The Sub-Committee may exclude the public from all or part of a hearing if it considers it is in the public interest to do so. Should any part of the hearing need to be held in private session, a separate private online meeting will be convened by the Sub-Committee. This video-conferencing platform will also be used for decision making in private. All paperwork relevant to the hearing will be published online on the Council's

website, 5 working days before the remote hearing. The documents will be produced in PDF format and will be paginated to permit ease of reference during the remote hearing. Name and address details of those making representations will be made public. Telephone numbers, email addresses and signatures will be omitted.

6. 5 working days before the remote hearing is due to take place, the Council will contact the parties with a list of issues they would like any party to specifically address them on or clarify at the hearing.
7. If in light of the Council's list of issues any party wishes to produce any further documentary evidence they should submit this to the Council by email three working days before the hearing.
8. Any documentary evidence that is not submitted to the Council by email three working days before the hearing will not be admitted without the agreement of all parties. If it is essential to a party's case that the material be admitted, then the Sub-Committee will consider adjourning the remote hearing to allow all parties a fair opportunity to consider it.
9. Should any party wish to rely on any points of law, specific references in the s.182 Guidance, specific references in the Council's Policy or any other external resources, these should be set down in an electronic document and submitted to the Council by email three working days before the hearing.

The Remote Licensing Hearing

10. The Applicant is permitted to speak at the remote hearing (see below). Ward Councillors, responsible Authorities and Representors are only permitted to speak if they have made written submissions during the consultation period. Any party to a hearing may be assisted or represented by any person, legally or otherwise.
11. All parties will be given a fair hearing and each party will have the same amount of time in which to address the Sub-Committee and question each other. Each party will have 15 minutes to address the Sub-Committee and call any witnesses and 5 minutes for questions.

12. However, where there are groups of individuals with a common interest, for example local residents making similar representations either for or against an application, consideration should be given to nominating a spokesperson. Otherwise the Sub-Committee may impose a time limit for such representations where there is pressure on the Sub-Committee to hear numerous applications in a short period of time or for any other valid reason.
13. If any Representors fail to attend the hearing, the Sub-Committee will normally proceed but will consider their written representation. In considering written evidence in the absence of a Representor, appropriate weight will be attached, given that the person cannot be questioned by Members.
14. **The Sub-Committee is required to disregard any information given or evidence produced by a party or witness which is not relevant to the application, representations, or notice, and the promotion of the licensing objectives.** Duplication should be avoided. Comments must be confined to those points already made, although the parties may expand on their written submissions. The Sub-Committee will have read and familiarised themselves with all the written submissions and the issues prior to the hearing, and therefore do not require the points to be made at length.
15. A Representor **may not** introduce any new ground or objection not referred to in their written submission. Additional representations which do not amount to an amplification of the original representation will not be considered by the Sub-Committee.
16. Any person behaving in a disruptive manner will be asked to leave the hearing. However, if this occurs, that person will be entitled to submit in writing any information they would have been entitled to give orally.

ORDER OF PROCEEDINGS AT THE REMOTE HEARING

Chair's introduction and opening comments

17. The Chair will introduce the Sub-Committee Members and Officers and welcome the Applicant and Representors (or their

representatives), and establish the identity of all who will be taking part.

18. The Chair will outline the procedure to be followed.

19. The Chair will proceed with the order of business on the agenda.

Licensing Manager

20. When the agenda item relating to the application is reached, the Chair will invite the Licensing Officer to present the application. The Chair will invite all present, one by one, to ask the Licensing Officer questions if they wish, to clarify any points raised in the report.

The Application

21. The Applicant (and/or their representative) will address the Sub-Committee and present information in support of the application and may call any witnesses to support the application, one witness at a time *[maximum 15 minutes]*.

22. The Chair will invite the Representors to ask questions of the Applicant in the following order [maximum 5 minutes each party]:

- Police;
- Other Responsible Authorities;
- Ward Councillors;
- Members of the Sub-Committee;
- The Sub-Committee's legal adviser.

The Representations

23. The Chair will invite the Representors and/or their representative in the following order to address the Members of the Sub-Committee and call any witnesses in support of their representation *[maximum 15 minutes each party]*:

- Police
- Other Responsible Authorities

- Ward Councillors
 - Public representation
24. The Chair will invite the Applicant to ask questions of each Representor and/or their witnesses after each presentation [maximum 5 minutes per Representor]. The Chair will invite the Committee Members to ask questions of each Representor (or their representative) and/or their witnesses after each presentation.
25. Where there are groups of individuals with a common interest, for example local residents, presentation through an appointed spokesperson is preferred but not mandated.

Summaries

26. The Chair will invite the Representors (or their representative) in the following order to summarise their case *[maximum 5 minutes each party]*
- Police
 - Other Responsible Authorities
 - Ward Councillors
 - Local residents
27. The Chair will invite the Applicant (or their representative) to summarise their case *[maximum 5 minutes]*.
28. The Chair will provide the Sub-Committee with a final opportunity to seek clarification from any of the parties on any points raised, or seek advice from the Licensing Officer on policy, or from the Legal Advisor on law and jurisdiction.

Determination

29. The Sub-Committee will withdraw to consider their decision with the Legal Adviser and the Democratic Services Officer in a separate private on line meeting. These officers will not comment on the merits of the application, but will be present to provide advice on legal and procedural points and to record the decision.

30. If the decision is made following the conclusion of the hearing, the Sub-Committee will return to the public online meeting to announce an outline of the decision to those present. This decision will then be communicated in full in writing, including reasons for the decision, to the Applicant and all Representors (whether in attendance or not) usually within 5 working days of the hearing. There can be no further questions or statements.
31. If the Sub-Committee does not make a decision on the day of the hearing, the decision will be made within 5 working days beginning with the day or the last day on which the hearing was held. The Democratic Services Officer will inform the parties that they are no longer required and the decision will be communicated in writing to the Applicant and Representors within 5 working days of the decision being made.

The notification will include information about the rights of appeal against the determination made.

City of York Council

Committee Minutes

Meeting	Licensing/Gambling Hearing
Date	13 June 2022
Present	Councillors Galvin, Melly and Wann

1. Chair

Resolved: That Cllr Melly be elected to chair the hearing.

2. Introductions

The Chair introduced the Sub-Committee Members, the Legal Adviser and the Democratic Services officer. The CYC Licensing Manager Lesley Cooke, the Tesco Licensing Manager Hardish Purewell, and the local Tesco Store Manager Emma Martin then introduced themselves.

3. Declarations of Interest

Members were invited to declare at this point in the meeting any disclosable pecuniary interest or other registerable interest they might have in respect of business on the agenda, if they had not already done so in advance on the Register of Interests. No interests were declared.

4. Exclusion of Press and Public

Resolved: That the press and public be excluded from the meeting during the sub-committee's deliberations and decision-making at the end of the hearing, on the grounds that the public interest in excluding the public outweighs the public interest in that part of the meeting taking place in public, under Regulation 14 of the Licensing Act 2003 (Hearings) Regulations 2005.

5. Minutes

Resolved: That the minutes of the Licensing Hearing held on 23 May 2022 be approved as a correct record, to be signed by the Chair at a later date, subject to the following amendment:

- in paragraph (vii) under 'Reasons', replace '*no evidence*' with '*insufficient evidence*'.

6. The Determination of a Section 18(3)(a) Application by Tesco Stores Ltd. for a Premises Licence in respect of 45 - 49 Gillygate, York, YO31 7EA (CYC-070642)

Members considered an application by Tesco Stores Ltd. for a premises licence in respect of 45-49 Gillygate, York YO31 7EA.

In considering the application and the representations made, the Sub-Committee concluded that the following licensing objectives were relevant to this Hearing:

1. The Prevention of Crime and Disorder
2. The Prevention of Public Nuisance

In coming to their decision, the Sub-Committee took into consideration all the evidence and submissions that were presented, and determined their relevance to the issues raised and the above licensing objectives, including:

1. The application form.
2. The papers before it, including the additional papers published in the Agenda Supplement and the written representations.
3. The Licensing Manager's report, and her comments at the Hearing.

The Licensing Manager outlined the report and the annexes, correcting two errors in paragraph 5 of the report and confirming that the licensable activities applied for included the supply of alcohol **off** the premises, and late night refreshment. She noted that the premises were not in the cumulative impact area and confirmed that the Applicant had carried out the consultation process correctly. She highlighted the additional conditions agreed by the Applicant with North Yorkshire Police, noting that the Police had subsequently withdrawn their objections. She drew attention to the two representations received from local residents, as set out in Annex 3. Finally, she advised the Sub Committee of the options open to them in determining the application.

4. The representations made by Hardish Purewal, Licensing Manager for Tesco, on behalf of Tesco Stores Limited (the Applicant).

Ms Purewal stated that this was a new application for premises due to open in October 2022. The premises would operate as a smaller convenience format or 'Express' store, with a range of approximately 5,000 lines targeted to the area. Alcohol was just a small, though important, part of this range. The Store Manager, Emma Martin, had a wealth of experience, having been with Tesco for 15 years and a store manager in York for 6 years, currently at Goodramgate. The store would employ about 20 colleagues and 3 shift managers and would provide roles for people in the local community, with a mixture of experienced and new staff. The recruitment process would take place 8 weeks before opening. There would be a range of carefully selected lines in store and alcohol miniatures would not be sold except in gift packs. Tesco took pride in being a good neighbour in the community and had awarded over £172,000 to groups and charities in the local area.

Ms Purewal went on to say that Tesco had a good relationship with the statutory authorities and she herself chaired a Retail Alcohol Standards group that advised on best practice across the industry and offered free guidance to smaller shops. Emma Martin was involved in the Pubwatch scheme, meeting with the local police and PCSOs; there had also been talk of a Retailwatch scheme in which she would be happy to take part. The training offered by Tesco was endorsed by the BII; training on alcohol sales and security was provided to staff twice a year as well as on joining. This included training on proxy sales and how to spot someone who was drunk. Conflict training was also provided on how to manage people who were drunk. Tesco operated a strong 'Think 25' policy and a 'you say no, we say no' rule, whereby a manager would not over-rule a decision by a member of staff to refuse a sale. CCTV Panic alarms, tags on high value items, bodycams, and headsets for quick communications between teams were all part of the security provided in stores. Central support was also provided, and the shop would be tested 4 times per year by an external audit

company to ensure it was following Think 25. Promotions were all set nationally. The application for late night refreshments was needed for the Costa coffee machine, for which payment was taken at the checkout.

With regard to the representations, Ms Purewal confirmed that the Applicant was happy to work with local community organisations to nip any problems in the bud, and that they already co-operated with police and rangers in the city in refusing alcohol to people involved in anti-social behaviour. The police were working on a multi-agency plan and the Applicant would fit in with that. Under the council's policy and the S182 guidance, permission was generally granted for shops to sell alcohol during their operating hours unless there was a reason not to; in this case there was no evidence to suggest any reason to refuse permission. The police had agreed conditions and the Applicant would work with them on any new issues that arose. The closing times of other premises were not relevant, as each application must be considered on its own merits.

In response to a question from the Chair, Ms Purewal said she was not aware of the recent decision to introduce a Public Space Protection Order in the area covering Gillygate, but that Tesco already operated a number of premises in other PSPO areas and would be happy to work with police on this.

Ms Purewal was then given to opportunity to sum up. She referred to the points already made in her submission, which she hoped had demonstrated that Tesco was an excellent operator with all the necessary policies and procedures in place, and stated that there was no evidence to suggest that the application should not be granted.

The Chair sought clarification with regard to the condition in the operating schedule relating to CCTV. Ms Purewal confirmed that the Applicant would be happy for this to include a requirement to make CCTV footage available to the responsible authorities on request.

In respect of the proposed licence, the Sub-Committee had to determine whether the licence application

demonstrated that the premises would not undermine the licensing objectives. Having regard to the above evidence and representations received, the Sub-Committee considered the steps which were available to them to take under Section 18(3) (a) of the Licensing Act 2003 as it considered necessary for the promotion of the Licensing Objectives:

- Option 1: Grant the licence in the terms applied for. This option was **rejected**.
- Option 2: Grant the licence with modified/additional conditions imposed by the licensing committee. This option was **approved**.
- Option 3: Grant the licence to exclude any of the licensable activities to which the application relates and modify/add conditions accordingly. This option was **rejected**.
- Option 4: Refuse to specify a person on the licence as premises supervisor. This option was **rejected**.
- Option 5: Reject the application. This option was **rejected**.

Resolved: That Option 2 be approved and the licence be granted with modified / additional conditions imposed by the Sub-Committee, as set out below:

Activity	Timings
Supply of alcohol – off the premises	Monday to Sunday 06:00 – midnight
Late night refreshment	Monday to Sunday 23:00 – midnight
Opening hours	Monday to Sunday 06:00 – midnight

The additional/modified conditions are as follows:

- (i) There shall be no sale of single cans of beer, lager or cider from the premises and no sales of single bottles of beer,

lager or cider in vessels of less than 500ml with the exception of premium craft products.

(ii) There will be no display of alcohol within 5 metres of the store entrance.

(iii) The premises licence holder or designated premises supervisor is responsible for risk assessing the need for door staff at the premises. Where engaged, door staff shall be licensed by the Security Industry Authority.

(iv) Viewing of CCTV images shall be made available immediately upon request of a Police officer or authorised officer of the Licensing Authority throughout the entire 31 day retention period [referred to in the CCTV condition in the operating schedule submitted by the Applicant].

No conditions have been removed from the operating schedule submitted by the Applicant.

Reasons: (i) The Sub-Committee must promote the licensing objectives and must have regard to the Guidance issued under section 182 of the Licensing Act 2003 and the Council's own Statement of Licensing Policy.

(ii) The Sub-Committee notes the local residents' concerns that the application would lead to crime and disorder and public nuisance and in particular that there has been a problem with street drinkers in the area.

(iii) They also note the conditions offered in the operating schedule to promote the licensing objectives, that there had been no objection to the application from the Responsible Authorities and that the Police had agreed conditions with the applicant to address potential issues relating to crime and disorder and anti- social behaviour.

(iv) The Sub-Committee considers that it has received sufficient assurances from the applicant in order to have a high level of confidence that the premises will be operated responsibly and that it can, with the imposition of suitable conditions,

operate without adding to or causing alcohol related problems in the area.

(v) The Sub-Committee considers that the grant of the application with the above mandatory and additional conditions will not undermine the promotion of the licensing objectives.

Cllr R Melly, Chair

[The meeting started at 10.00 am and finished at 10.40 am].

This page is intentionally left blank



Licensing Act 2003 Sub Committee**Date: 11 July 2022**

Report from the Director – Environment, Transport & Planning

Section 18(3) (a) Application for a premises licence for The Old Butcher's Coffee Shop, 16a York Street, Dunnington, York, YO19 5PN**Summary**

1. This report seeks Members' determination of an application for the grant of a premises licence, which has been made under the Licensing Act 2003.
2. Application reference number: CYC - 070776
3. Name of applicant: Bad Habits Coffee Bar Limited
4. Type of authorisation applied for: Grant of Premises Licence
5. Summary of application:

The proposal is to allow for the provision of the following activities at a coffee shop/bistro at 16a York Street, Dunnington:

Proposed Activity	Timings
Supply of alcohol – on and of the premises	12:00 to 22:30 everyday
Opening hours	09:00 to 23:00 everyday

Background

6. A copy of the application can be found at Annex 1, including a plan(s) of the premises. Please note the above hours have been amended and reduced by the applicant from the hours in the original application form. **The timings stated in the table above are the hours being applied for.**

7. The premises is described in the application as a ground floor coffee shop and bistro that can accommodate 30 people, fully fitted with a commercial kitchen serving hot food.
8. An overview of the circumstances in which entertainment activities are not licensable can be found at Annex 2.

Promotion of Licensing Objectives

9. The operating schedule submitted by the applicant shows that the licensing objectives would be met as follows:

10. General

- Appropriate instruction, training and supervision of those employed.
- Adoption of best practice guidance
- Provision of litter bins and other security measures such as outside lighting

11. The Prevention of Crime and Disorder

- Effective and responsible management of the premises

12. Public Safety

- Provision of sufficient number of people employed or engaged to secure the safety of the premises and patrons

13. The Prevention of Public Nuisance

- Control of operating hours
- Collection and disposal of litter
- Appropriate instruction, training and supervision to prevent incidents of public nuisance

14. The Protection of Children from Harm

- Appropriate instruction, training and supervision of the staff in respect to determining the age of a customer

- Acceptance of accredited 'proof of age' cards and/or photo driving licences

Special Policy Consideration

15. This premises is not located within the cumulative impact area.

Consultation

16. Consultation was carried out by the applicant in accordance with s13, and s17 (5) of the Act and Regulation 42, Parts 2 and 4 of the Licensing Act 2003 (Premises Licences and Club Premises Certificates) Regulations 2005, which concern the displaying of a notice on the premises and an advertisement in a local paper giving details of the application and serving a copy of the application on all responsible authorities. The applicant complied with all statutory requirements. In addition the relevant ward councillors and/or parish council were notified by way of register.
17. All procedural aspects of this application have been complied with.

Summary of Representations made by Responsible Authorities

18. North Yorkshire Police have agreed with the applicant to add additional conditions to the licence if granted, the conditions can be found can be found at Annex 3. Therefore North Yorkshire Police do not oppose this application.

Summary of Representations made by Other Parties

19. There have been 2 relevant representations received from other persons. The list of representors is attached at Annex 4.
20. The representations are predominantly based on the grounds of the prevention of public nuisance objectives. They state that this objective will be undermined if the application is granted.
21. A copy of all the representations are attached at Annex 5.
22. A map showing the general area around the venue is attached at Annex 6.
23. The mandatory conditions that will be attached to this licence if granted (if they apply) can be found at Annex 7. The Legislation and Policy considerations can be found at Annex 8.

Options

24. By virtue of s18(4) of the Act, the Committee have the following options available to them in making their decision: -
25. Option 1: Grant the licence in the terms applied for.
26. Option 2: Grant the licence with modified/additional conditions imposed by the licensing committee.
27. Option 3: Grant the licence to exclude any of the licensable activities to which the application relates and modify/add conditions accordingly.
28. Option 4: Refuse to specify a person on the licence as premises supervisor.
29. Option 5: Reject the application.

Analysis

30. The following could be the result of any decision made this Sub Committee:-
31. Option 1: This decision could be appealed at Magistrates Court by any of the representors.
32. Option 2: This decision could be appealed at Magistrates Court by the applicant or any of the representors.
33. Option 3: This decision could be appealed at Magistrates Court by the applicant or any of the representors.
34. Option 4: This decision could be appealed at Magistrates Court by the applicant.
35. Option 5: This decision could be appealed at Magistrates Court by the applicant.

Council Plan

36. The Licensing Act 2003 has four objectives the prevention of crime and disorder, public safety, prevention of public nuisance and the protection of children from harm.
37. By taking the statutory requirements of the Licensing Act into consideration, as well as the four licensing objectives when

determining licensing applications the Council are supporting the new and existing licence trade, as well as local residents and businesses. The functions support the Council's Plan of safe communities and culture for all, and a good quality of life for everyone.

Implications

38.

- **Financial** - N/A
- **Human Resources (HR)** – N/A
- **Equalities** – N/A
- **Legal** – This decision could be appealed at Magistrates Court by the applicant or any of the representors.
- **Crime and Disorder** - The Committee is reminded of their duty under the Crime and Disorder Act 1998 to consider the crime and disorder implications of their decisions and the authority's responsibility to co-operate in the reduction of crime and disorder in the city.
- **Information Technology (IT)** – N/A
- **Property** – N/A
- **Other** – none

Risk Management

39. All Members of the Licensing Act 2003 Committee have received full training on the Act and the regulations governing hearings. They are aware that any decision made which is unreasonable or unlawful could be open to challenge resulting in loss of image, reputation and potential financial penalty.
40. The report details the options available to the panel in determining the application and recommends that a decision be reached. There are no risks involved with this recommendation.

Recommendations

41. Members determine the application.

Reason: To address the representations received as required by the Licensing Act 2003.

Contact Details

Author:

Lesley Cooke
Licensing Manager

Chief Officer Responsible for the report:

James Gilchrist
Director Environment, Transport & Planning

Tel No. 01904 551515

**Report
Approved**

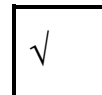

Date
21.06.2022

Specialist Implications Officer(s)

Head of Legal & Democratic Services
Ext: 1004

Wards Affected: Osbaldwick & Derwent



For further information please contact the author of the report

Background Papers:

- Annex 1** - Application form
- Annex 2** - Overview of Circumstances in which Entertainment Activities are not Licensable
- Annex 3** - Conditions agreed with North Yorkshire Police
- Annex 4** - List of Representors
- Annex 5** - Representations
- Annex 6** - Map of area
- Annex 7** - Mandatory Conditions
- Annex 8** - Legislation and policy



CITY OF YORK COUNCIL
Licensing Services, Hazel Court EcoDepot, James Street,
York, YO10 3DS

Application for a premises licence to be granted under the Licensing Act 2003

PLEASE READ THE FOLLOWING INSTRUCTIONS FIRST

Before completing this form please read the guidance notes at the end of the form. If you are completing this form by hand please write legibly in block capitals. In all cases ensure that your answers are inside the boxes and written in black ink. Use additional sheets if necessary.

You may wish to keep a copy of the completed form for your records.

I/We BAD HABITS COFFEE BAR LIMITED

(Insert name(s) of applicant)

apply for a premises licence under section 17 of the Licensing Act 2003 for the premises described in Part 1 below (the premises) and I/we are making this application to you as the relevant licensing authority in accordance with section 12 of the Licensing Act 2003

Part 1 – Premises details

Postal address of premises or, if none, ordnance survey map reference or description

THE OLD BUTCHERS COFFEE SHOP
Address: 16A YORK STREET

Post town	DUNNINGTON	Postcode	YO19 5PN
------------------	------------	-----------------	----------

Telephone number at premises (if any)	
---------------------------------------	--

Non-domestic rateable value of premises	£ 5000
---	--------

Part 2 - Applicant details

Please state whether you are applying for a premises licence as

Please tick as appropriate

- | | | | |
|-----|--|-------------------------------------|-----------------------------|
| a) | an individual or individuals * | <input type="checkbox"/> | please complete section (A) |
| b) | a person other than an individual * | | |
| i | as a limited company/limited liability partnership | <input checked="" type="checkbox"/> | please complete section (B) |
| ii | as a partnership (other than limited liability) | <input type="checkbox"/> | please complete section (B) |
| iii | as an unincorporated association or | <input type="checkbox"/> | please complete section (B) |

- iv other (for example a statutory corporation) ☐ please complete section (B)
- c) a recognised club ☐ please complete section (B)
- d) a charity ☐ please complete section (B)
- e) the proprietor of an educational establishment ☐ please complete section (B)
- f) a health service body ☐ please complete section (B)
- g) a person who is registered under Part 2 of the Care Standards Act 2000 (c14) in respect of an independent hospital in Wales ☐ please complete section (B)
- ga) a person who is registered under Chapter 2 of Part 1 of the Health and Social Care Act 2008 (within the meaning of that Part) in an independent hospital in England ☐ please complete section (B)
- h) the chief officer of police of a police force in England and Wales ☐ please complete section (B)

* If you are applying as a person described in (a) or (b) please confirm (by ticking yes to one box below):

I am carrying on or proposing to carry on a business which involves the use of the premises for licensable activities; or ☒

I am making the application pursuant to a

statutory function or ☐

a function discharged by virtue of Her Majesty's prerogative ☐

(A) INDIVIDUAL APPLICANTS (fill in as applicable)

Mr <input type="checkbox"/>	Mrs <input type="checkbox"/>	Miss <input type="checkbox"/>	Ms <input type="checkbox"/>	Other Title (for example, Rev)	
Surname			First names		
Date of birth			I am 18 years old or over <input type="checkbox"/> Please tick yes		
Nationality					
Current residential address if different from premises address					
Post town				Postcode	
Daytime contact telephone number					
E-mail address (optional)					
Where applicable (if demonstrating a right to work via the Home Office online right to work checking service), the 9-digit 'share code' provided to the applicant by that service (please see					

note 15 for information)

SECOND INDIVIDUAL APPLICANT (if applicable)

Mr <input type="checkbox"/>	Mrs <input type="checkbox"/>	Miss <input type="checkbox"/>	Ms <input type="checkbox"/>	Other Title (for example, Rev)	
Surname			First names		
Date of birth			I am 18 years old or over <input type="checkbox"/> Please tick yes		
Nationality					
Where applicable (if demonstrating a right to work via the Home Office online right to work checking service), the 9-digit 'share code' provided to the applicant by that service: (please see note 15 for information)					
Current residential address if different from premises address					
Post town				Postcode	
Daytime contact telephone number					
E-mail address (optional)					

(B) OTHER APPLICANTS

Please provide name and registered address of applicant in full. Where appropriate please give any registered number. In the case of a partnership or other joint venture (other than a body corporate), please give the name and address of each party concerned.

Name	BAD HABITS COFFEE BAR LIMITED
Address	16A YORK STREET, DUNNINGTON POST CODE: YO19 5PN
Registered number (where applicable)	13509379

Description of applicant (for example, partnership, company, unincorporated association etc.) LIMITED COMPANY
Telephone number (if any) 0 589500
E-mail address (optional) 22a.m@p.d.c.

Part 3 Operating Schedule

When do you want the premises licence to start?

DD	MM	YYYY
1	0	062022

If you wish the licence to be valid only for a limited period, when do you want it to end?

DD	MM	YYYY

Please give a general description of the premises (please read guidance note 1)
A ground floor coffee shop and bistro that can accomodate 30 people, fully fitted with a commercial kitchen serving hot food.

If 5,000 or more people are expected to attend the premises at any one time, please state the number expected to attend.

N/A

What licensable activities do you intend to carry on from the premises?

(please see sections 1 and 14 and Schedules 1 and 2 to the Licensing Act 2003)

Provision of regulated entertainment (please read guidance note 2)

Please tick all that apply

- a) plays (if ticking yes, fill in box A) ☐
- b) films (if ticking yes, fill in box B) ☐
- c) indoor sporting events (if ticking yes, fill in box C) ☐
- d) boxing or wrestling entertainment (if ticking yes, fill in box D) ☐
- e) live music (if ticking yes, fill in box E) ☐

- f) recorded music (if ticking yes, fill in box F) ☐
- g) performances of dance (if ticking yes, fill in box G) ☐
- h) anything of a similar description to that falling within (e), (f) or (g)
(if ticking yes, fill in box H) ☐

Provision of late night refreshment (if ticking yes, fill in box I) ☐

Supply of alcohol (if ticking yes, fill in box J) ☒

In all cases complete boxes K, L and M

A

Plays Standard days and timings (please read guidance note 7)			<u>Will the performance of a play take place indoors or outdoors or both – please tick</u> (please read guidance note 3)	Indoors	<input type="checkbox"/>
				Outdoors	<input type="checkbox"/>
				Both	<input type="checkbox"/>
Day	Start	Finish	<u>Please give further details here</u> (please read guidance note 4)		
Mon					
Tue					
Wed			<u>State any seasonal variations for performing plays</u> (please read guidance note 5)		
Thur					
Fri					
Sat			<u>Non standard timings. Where you intend to use the premises for the performance of plays at different times to those listed in the column on the left, please list</u> (please read guidance note 6)		
Sun					

B

Films Standard days and timings (please read guidance note 7)			<u>Will the exhibition of films take place indoors or outdoors or both – please tick</u> (please read guidance note 3)	Indoors	<input type="checkbox"/>
				Outdoors	<input type="checkbox"/>
				Both	<input type="checkbox"/>
Day	Start	Finish			
Mon			<u>Please give further details here</u> (please read guidance note 4)		
Tue					
Wed			<u>State any seasonal variations for the exhibition of films</u> (please read guidance note 5)		
Thur					
Fri			<u>Non standard timings. Where you intend to use the premises for the exhibition of films at different times to those listed in the column on the left, please list</u> (please read guidance note 6)		
Sat					
Sun					

C

Indoor sporting events Standard days and timings (please read guidance note 7)			<u>Please give further details</u> (please read guidance note 4)
Day	Start	Finish	
Mon			
Tue			<u>State any seasonal variations for indoor sporting events</u> (please read guidance note 5)
Wed			
Thur			
Fri			<u>Non standard timings. Where you intend to use the premises for indoor sporting events at different times to those listed in the column on the left, please list</u> (please read guidance note 6)
Sat			
Sun			

D

Boxing or wrestling entertainments Standard days and timings (please read guidance note 7)			<u>Will the boxing or wrestling entertainment take place indoors or outdoors or both – please tick</u> (please read guidance note 3)	Indoors	<input type="checkbox"/>
				Outdoors	<input type="checkbox"/>
				Both	<input type="checkbox"/>
Day	Start	Finish	<u>Please give further details here</u> (please read guidance note 4)		
Mon					
Tue			<u>Please give further details here</u> (please read guidance note 4)		
Wed			<u>State any seasonal variations for boxing or wrestling entertainment</u> (please read guidance note 5)		
Thur			<u>State any seasonal variations for boxing or wrestling entertainment</u> (please read guidance note 5)		
Fri			<u>Non standard timings. Where you intend to use the premises for boxing or wrestling entertainment at different times to those listed in the column on the left, please list</u> (please read guidance note 6)		
Sat					
Sun			<u>Non standard timings. Where you intend to use the premises for boxing or wrestling entertainment at different times to those listed in the column on the left, please list</u> (please read guidance note 6)		

E

Live music Standard days and timings (please read guidance note 7)			<u>Will the performance of live music take place indoors or outdoors or both – please tick</u> (please read guidance note 3)		Indoors	<input type="checkbox"/>
					Outdoors	<input type="checkbox"/>
					Both	<input type="checkbox"/>
Day	Start	Finish	<u>Please give further details here</u> (please read guidance note 4)			
Mon						
Tue						
Wed			<u>State any seasonal variations for the performance of live music</u> (please read guidance note 5)			
Thur						
Fri						
Sat			<u>Non standard timings. Where you intend to use the premises for the performance of live music at different times to those listed in the column on the left, please list</u> (please read guidance note 6)			
Sun						

F

Recorded music Standard days and timings (please read guidance note 7)			<u>Will the playing of recorded music take place indoors or outdoors or both – please tick</u> (please read guidance note 3)	Indoors	<input type="checkbox"/>
				Outdoors	<input type="checkbox"/>
				Both	<input type="checkbox"/>
Day	Start	Finish	<u>Please give further details here</u> (please read guidance note 4)		
Mon					
Tue					
Wed			<u>State any seasonal variations for the playing of recorded music</u> (please read guidance note 5)		
Thur					
Fri					
Sat			<u>Non standard timings. Where you intend to use the premises for the playing of recorded music at different times to those listed in the column on the left, please list</u> (please read guidance note 6)		
Sun					

G

Performances of dance Standard days and timings (please read guidance note 7)			<u>Will the performance of dance take place indoors or outdoors or both – please tick</u> (please read guidance note 3)	Indoors	<input type="checkbox"/>
				Outdoors	<input type="checkbox"/>
				Both	<input type="checkbox"/>
Day	Start	Finish	<u>Please give further details here</u> (please read guidance note 4)		
Mon					
Tue			<u>State any seasonal variations for the performance of dance</u> (please read guidance note 5)		
Wed					
Thur			<u>Non standard timings. Where you intend to use the premises for the performance of dance at different times to those listed in the column on the left, please list</u> (please read guidance note 6)		
Fri					
Sat					
Sun					

H

Anything of a similar description to that falling within (e), (f) or (g) Standard days and timings (please read guidance note 7)			Please give a description of the type of entertainment you will be providing		
Day	Start	Finish	<u>Will this entertainment take place indoors or outdoors or both – please tick</u> (please read guidance note 3)	Indoors	<input type="checkbox"/>
Mon				Outdoors	<input type="checkbox"/>
				Both	<input type="checkbox"/>
Tue			<u>Please give further details here</u> (please read guidance note 4)		
Wed					
Thur			<u>State any seasonal variations for entertainment of a similar description to that falling within (e), (f) or (g)</u> (please read guidance note 5)		
Fri					
Sat			<u>Non standard timings. Where you intend to use the premises for the entertainment of a similar description to that falling within (e), (f) or (g) at different times to those listed in the column on the left, please list</u> (please read guidance note 6)		
Sun					

I

Late night refreshment Standard days and timings (please read guidance note 7)			Will the provision of late night refreshment take place indoors or outdoors or both – please tick (please read guidance note 3)	Indoors	<input type="checkbox"/>
				Outdoors	<input type="checkbox"/>
				Both	<input type="checkbox"/>
Day	Start	Finish	<u>Please give further details here</u> (please read guidance note 4)		
Mon					
Tue			<u>State any seasonal variations for the provision of late night refreshment</u> (please read guidance note 5)		
Wed					
Thur			<u>Non standard timings. Where you intend to use the premises for the provision of late night refreshment at different times, to those listed in the column on the left, please list</u> (please read guidance note 6)		
Fri					
Sat					
Sun					

J

Supply of alcohol Standard days and timings (please read guidance note 7)			<u>Will the supply of alcohol be for consumption – please tick</u> (please read guidance note 8)	On the premises	<input type="checkbox"/>
				Off the premises	<input type="checkbox"/>
				Both	<input checked="" type="checkbox"/>
Day	Start	Finish	<u>State any seasonal variations for the supply of alcohol</u> (please read guidance note 5) N/A.		
Mon	10:00	23:00			
Tue	10:00	23:00			
Wed	10:00	23:00			
Thur	10:00	23:00	<u>Non standard timings. Where you intend to use the premises for the supply of alcohol at different times to those listed in the column on the left, please list</u> (please read guidance note 6) N/A.		
Fri	10:00	23:00			
Sat	10:00	23:00			
Sun	10:00	23:00			

State the name and details of the individual whom you wish to specify on the licence as designated premises supervisor (Please see declaration about the entitlement to work in the checklist at the end of the form):

Name GIANNIS SIDIROPOULOS	
Date of birth ●●●●	
Address ●●●●●●●● STREET, YORK	
Postcode ●●●●	
Personal licence number (if known) CYC- 070716	
Issuing licensing authority (if known) CITY OF YORK COUNCIL	

K

Please highlight any adult entertainment or services, activities, other entertainment or matters ancillary to the use of the premises that may give rise to concern in respect of children (please read guidance note 9).

N/A.

L

Hours premises are open to the public Standard days and timings (please read guidance note 7)			<u>State any seasonal variations</u> (please read guidance note 5) N/A.
Day	Start	Finish	<u>Non standard timings. Where you intend the premises to be open to the public at different times from those listed in the column on the left, please list</u> (please read guidance note 6) N/A.
Mon	09:00	22:30	
Tue	09:00	22:30	
Wed	09:00	22:30	
Thur	09:00	22:30	
Fri	09:00	22:30	
Sat	09:00	22:30	
Sun	09:00	22:30	

M

Describe the steps you intend to take to promote the four licensing objectives:

a) General – all four licensing objectives (b, c, d and e) (please read guidance note 10)

APPROPRIATE INSTRUCTION, TRAINING AND SUPERVISION OF THOSE EMPLOYED
ADOPTION OF BEST PRACTICE GUIDANCE
PROVISION OF LITTER BINS AND OTHER SECURITY MEASURES SUCH AS OUTSIDE LIGHTING

b) The prevention of crime and disorder

EFFECTIVE AND RESPONSIBLE MANAGEMENT OF THE PREMISES

c) Public safety

PROVISION OF SUFFICIENT NUMBER OF PEOPLE EMPLOYED OR
ENGAGED TO SECURE THE SAFETY OF THE PREMISES AND PATRONS

d) The prevention of public nuisance

CONTROL OF OPERATING HOURS
COLLECTION AND DISPOSAL OF LITTER
APPROPRIATE INSTRUCTION, TRAINING AND SUPERVISION TO PREVENT
INCIDENTS OF PUBLIC NUISANCE

e) The protection of children from harm

APPROPRIATE INSTRUCTION, TRAINING AND SUPERVISION OF THE STUFF
IN RESPECT TO DETERMINING THE AGE OF A CUSTOMER
ACCEPTANCE OF ACCREDITED "PROOF OF AGE" CARDS AND/OR
"PHOTO" DRIVING LICENSES

Checklist:

Please tick to indicate agreement

- I have made or enclosed payment of the fee. ☒
- I have enclosed the plan of the premises. ☒
- I have sent copies of this application and the plan to responsible authorities and others where applicable. ☒
- I have enclosed the consent form completed by the individual I wish to be designated premises supervisor, if applicable. ☒
- I understand that I must now advertise my application. ☒
- I understand that if I do not comply with the above requirements my application will be rejected. ☒
- [Applicable to all individual applicants, including those in a partnership which is not a limited liability partnership, but not companies or limited liability partnerships] I have included documents demonstrating my entitlement to work in the United Kingdom or my share code issued by the Home Office online right to work checking service (please read note 15). ☐

IT IS AN OFFENCE, UNDER SECTION 158 OF THE LICENSING ACT 2003, TO MAKE A FALSE STATEMENT IN OR IN CONNECTION WITH THIS APPLICATION. THOSE WHO MAKE A FALSE STATEMENT MAY BE LIABLE ON SUMMARY CONVICTION TO A FINE OF ANY AMOUNT.

IT IS AN OFFENCE UNDER SECTION 24B OF THE IMMIGRATION ACT 1971 FOR A PERSON TO WORK WHEN THEY KNOW, OR HAVE REASONABLE CAUSE TO BELIEVE, THAT THEY ARE DISQUALIFIED FROM DOING SO BY REASON OF THEIR IMMIGRATION STATUS. THOSE WHO EMPLOY AN ADULT WITHOUT LEAVE OR WHO IS SUBJECT TO CONDITIONS AS TO EMPLOYMENT WILL BE LIABLE TO A CIVIL PENALTY UNDER SECTION 15 OF THE IMMIGRATION, ASYLUM AND NATIONALITY ACT 2006 AND PURSUANT TO SECTION 21 OF THE SAME ACT, WILL BE COMMITTING AN OFFENCE WHERE THEY DO SO IN THE KNOWLEDGE, OR WITH REASONABLE CAUSE TO BELIEVE, THAT THE EMPLOYEE IS DISQUALIFIED.

Part 4 – Signatures (please read guidance note 11)

Signature of applicant or applicant’s solicitor or other duly authorised agent (see guidance note 12). **If signing on behalf of the applicant, please state in what capacity.**

Declaration	<ul style="list-style-type: none"> • [Applicable to individual applicants only, including those in a partnership which is not a limited liability partnership] I understand I am not entitled to be issued with a licence if I do not have the entitlement to live and work in the UK (or if I am subject to a condition preventing me from doing work relating to the carrying on of a licensable activity) and that my licence will become invalid if I cease to be entitled to live and work in the UK (please read guidance note 15). • The DPS named in this application form is entitled to work in the UK (and is not subject to conditions preventing him or her from doing work relating to a licensable activity) and I have seen a copy of his or her
--------------------	--

	proof of entitlement to work, or have conducted an online right to work check using the Home Office online right to work checking service which confirmed their right to work (please see note 15)
Signature	
Date	12/05/2022
Capacity	DIRECTOR

For joint applications, signature of 2nd applicant or 2nd applicant's solicitor or other authorised agent (please read guidance note 13). If signing on behalf of the applicant, please state in what capacity.

Signature	
Date	
Capacity	

Contact name (where not previously given) and postal address for correspondence associated with this application (please read guidance note 14)

RAZVAN PAVEL
16A YORK STREET

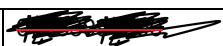
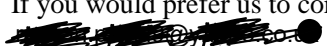
Post town	DUNNINGTON	Postcode	YO19 5PN
Telephone number (if any)			
If you would prefer us to correspond with you by e-mail, your e-mail address (optional)			
			

Notes for Guidance

1. Describe the premises, for example the type of premises, its general situation and layout and any other information which could be relevant to the licensing objectives. Where your application includes off-supplies of alcohol and you intend to provide a place for consumption of these off-supplies, you must include a description of where the place will be and its proximity to the premises.
2. In terms of specific regulated entertainments please note that:
 - Plays: no licence is required for performances between 08:00 and 23.00 on any day, provided that the audience does not exceed 500.
 - Films: no licence is required for 'not-for-profit' film exhibition held in community premises between 08.00 and 23.00 on any day provided that the audience does not exceed 500 and the organiser (a) gets consent to the screening from a person who is responsible for the premises; and (b) ensures that each such screening abides by age classification ratings.
 - Indoor sporting events: no licence is required for performances between 08.00 and 23.00 on any day, provided that the audience does not exceed 1000.
 - Boxing or Wrestling Entertainment: no licence is required for a contest, exhibition or display of Greco-Roman wrestling, or freestyle wrestling between 08.00 and 23.00 on any day, provided that the audience does not exceed 1000. Combined fighting sports – defined as a contest, exhibition or display which combines boxing or wrestling with one or more martial arts – are licensable as a boxing or wrestling entertainment rather than an indoor sporting event.
 - Live music: no licence permission is required for:
 - a performance of unamplified live music between 08.00 and 23.00 on any day, on any premises.
 - a performance of amplified live music between 08.00 and 23.00 on any day on premises authorised to sell alcohol for consumption on those premises, provided that the audience does not exceed 500.
 - a performance of amplified live music between 08.00 and 23.00 on any day, in a workplace that is not licensed to sell alcohol on those premises, provided that the audience does not exceed 500.
 - a performance of amplified live music between 08.00 and 23.00 on any day, in a church hall, village hall, community hall, or other similar community premises, that is not licensed by a premises licence to sell alcohol, provided that (a) the audience does not exceed 500, and (b) the organiser gets consent for the performance from a person who is responsible for the premises.
 - a performance of amplified live music between 08.00 and 23.00 on any day, at the non-residential premises of (i) a local authority, or (ii) a school, or (iii) a hospital, provided that (a) the audience does not exceed 500, and (b) the organiser gets consent for the performance on the relevant premises from: (i) the local authority concerned, or (ii) the school or (iii) the health care provider for the hospital.
 - Recorded Music: no licence permission is required for:
 - any playing of recorded music between 08.00 and 23.00 on any day on premises authorised to sell alcohol for consumption on those premises, provided that the audience does not exceed 500.
 - any playing of recorded music between 08.00 and 23.00 on any day, in a church hall, village hall, community hall, or other similar community premises, that is not licensed by a premises licence to sell alcohol, provided that (a) the audience does not exceed 500, and (b) the organiser gets consent for the performance from a person who is responsible for the premises.
 - any playing of recorded music between 08.00 and 23.00 on any day, at the non-residential premises of (i) a local authority, or (ii) a school, or (iii) a hospital, provided that (a) the audience does not exceed 500, and

- (b) the organiser gets consent for the performance on the relevant premises from: (i) the local authority concerned, or (ii) the school proprietor or (iii) the health care provider for the hospital.
- Dance: no licence is required for performances between 08.00 and 23.00 on any day, provided that the audience does not exceed 500. However, a performance which amounts to adult entertainment remains licensable.
 - Cross activity exemptions: no licence is required between 08.00 and 23.00 on any day, with no limit on audience size for:
 - any entertainment taking place on the premises of the local authority where the entertainment is provided by or on behalf of the local authority;
 - any entertainment taking place on the hospital premises of the health care provider where the entertainment is provided by or on behalf of the health care provider;
 - any entertainment taking place on the premises of the school where the entertainment is provided by or on behalf of the school proprietor; and
 - any entertainment (excluding films and a boxing or wrestling entertainment) taking place at a travelling circus, provided that (a) it takes place within a moveable structure that accommodates the audience, and (b) that the travelling circus has not been located on the same site for more than 28 consecutive days.
3. Where taking place in a building or other structure please tick as appropriate (indoors may include a tent).
 4. For example the type of activity to be authorised, if not already stated, and give relevant further details, for example (but not exclusively) whether or not music will be amplified or unamplified.
 5. For example (but not exclusively), where the activity will occur on additional days during the summer months.
 6. For example (but not exclusively), where you wish the activity to go on longer on a particular day e.g. Christmas Eve.
 7. Please give timings in 24 hour clock (e.g. 16.00) and only give details for the days of the week when you intend the premises to be used for the activity.
 8. If you wish people to be able to consume alcohol on the premises, please tick 'on the premises'. If you wish people to be able to purchase alcohol to consume away from the premises, please tick 'off the premises'. If you wish people to be able to do both, please tick 'both'.
 9. Please give information about anything intended to occur at the premises or ancillary to the use of the premises which may give rise to concern in respect of children, regardless of whether you intend children to have access to the premises, for example (but not exclusively) nudity or semi-nudity, films for restricted age groups or the presence of gaming machines.
 10. Please list here steps you will take to promote all four licensing objectives together.
 11. The application form must be signed.
 12. An applicant's agent (for example solicitor) may sign the form on their behalf provided that they have actual authority to do so.
 13. Where there is more than one applicant, each of the applicants or their respective agent must sign the application form.
 14. This is the address which we shall use to correspond with you about this application.

15. Entitlement to work/immigration status for individual applicants and applications from partnerships which are not limited liability partnerships:

A licence may not be held by an individual or an individual in a partnership who is resident in the UK who:

- does not have the right to live and work in the UK; or
- is subject to a condition preventing him or her from doing work relating to the carrying on of a licensable activity.

Any premises licence issued in respect of an application made on or after 6 April 2017 will become invalid if the holder ceases to be entitled to work in the UK.

Applicants must demonstrate that they have an entitlement to work in the UK and are not subject to a condition preventing them from doing work relating to the carrying on of a licensable activity. They do this in one of two ways: 1) by providing with this application copies or scanned copies of the documents listed below (which do not need to be certified), or 2) by providing their 'share code' to enable the licensing authority to carry out a check using the Home Office online right to work checking service (see below).

Documents which demonstrate entitlement to work in the UK

- An expired or current passport showing the holder, or a person named in the passport as the child of the holder, is a British citizen or a citizen of the UK and Colonies having the right of abode in the UK [please see note below about which sections of the passport to copy].
- An expired or current passport or national identity card showing the holder, or a person named in the passport as the child of the holder, is a national of a European Economic Area country or Switzerland.
- A Registration Certificate or document certifying permanent residence issued by the Home Office to a national of a European Economic Area country or Switzerland.
- A Permanent Residence Card issued by the Home Office to the family member of a national of a European Economic Area country or Switzerland.
- A **current** Biometric Immigration Document (Biometric Residence Permit) issued by the Home Office to the holder indicating that the person named is allowed to stay indefinitely in the UK, or has no time limit on their stay in the UK.
- A **current** passport endorsed to show that the holder is exempt from immigration control, is allowed to stay indefinitely in the UK, has the right of abode in the UK, or has no time limit on their stay in the UK.
- A **current** Immigration Status Document issued by the Home Office to the holder with an endorsement indicating that the named person is allowed to stay indefinitely in the UK or has no time limit on their stay in the UK, **when produced in combination with** an official document giving the person's permanent National Insurance number and their name issued by a Government agency or a previous employer.
- A birth or adoption certificate issued in the UK, **when produced in combination with** an official document giving the person's permanent National Insurance number and their name issued by a Government agency or a previous employer.
- A birth or adoption certificate issued in the Channel Islands, the Isle of Man or Ireland **when produced in combination with** an official document giving the person's permanent National Insurance number and their name issued by a Government agency or a previous employer.

- A certificate of registration or naturalisation as a British citizen, **when produced in combination with** an official document giving the person's permanent National Insurance number and their name issued by a Government agency or a previous employer.
- A **current** passport endorsed to show that the holder is allowed to stay in the UK and is currently allowed to work and is not subject to a condition preventing the holder from doing work relating to the carrying on of a licensable activity.
- A **current** Biometric Immigration Document (Biometric Residence Permit) issued by the Home Office to the holder which indicates that the named person can currently stay in the UK and is allowed to work relation to the carrying on of a licensable activity.
- A **current** Residence Card issued by the Home Office to a person who is not a national of a European Economic Area state or Switzerland but who is a family member of such a national or who has derivative rights or residence.
- A **current** Immigration Status Document containing a photograph issued by the Home Office to the holder with an endorsement indicating that the named person may stay in the UK, and is allowed to work and is not subject to a condition preventing the holder from doing work relating to the carrying on of a licensable activity **when produced in combination with** an official document giving the person's permanent National Insurance number and their name issued by a Government agency or a previous employer.
- A Certificate of Application, **less than 6 months old**, issued by the Home Office under regulation 18(3) or 20(2) of the Immigration (European Economic Area) Regulations 2016, to a person who is not a national of a European Economic Area state or Switzerland but who is a family member of such a national or who has derivative rights of residence.
- Reasonable evidence that the person has an outstanding application to vary their permission to be in the UK with the Home Office such as the Home Office acknowledgement letter or proof of postage evidence, or reasonable evidence that the person has an appeal or administrative review pending on an immigration decision, such as an appeal or administrative review reference number.
- Reasonable evidence that a person who is not a national of a European Economic Area state or Switzerland but who is a family member of such a national or who has derivative rights of residence in exercising treaty rights in the UK including:
 - evidence of the applicant's own identity – such as a passport,
 - evidence of their relationship with the European Economic Area family member – e.g. a marriage certificate, civil partnership certificate or birth certificate, and
 - evidence that the European Economic Area national has a right of permanent residence in the UK or is one of the following if they have been in the UK for more than 3 months:
 - (i) working e.g. employment contract, wage slips, letter from the employer,

- (ii) self-employed e.g. contracts, invoices, or audited accounts with a bank,
- (iii) studying e.g. letter from the school, college or university and evidence of sufficient funds; or
- (iv) self-sufficient e.g. bank statements.

Family members of European Economic Area nationals who are studying or financially independent must also provide evidence that the European Economic Area national and any family members hold comprehensive sickness insurance in the UK. This can include a private medical insurance policy, an EHIC card or an S1, S2 or S3 form.

Original documents must not be sent to licensing authorities. If the document copied is a passport, a copy of the following pages should be provided:

- (i) any page containing the holder's personal details including nationality;
- (ii) any page containing the holder's photograph;
- (iii) any page containing the holder's signature;
- (iv) any page containing the date of expiry; and
- (v) any page containing information indicating the holder has permission to enter or remain in the UK and is permitted to work.

If the document is not a passport, a copy of the whole document should be provided.

Your right to work will be checked as part of your licensing application and this could involve us checking your immigration status with the Home Office. We may otherwise share information with the Home Office. Your licence application will not be determined until you have complied with this guidance.

Home Office online right to work checking service

As an alternative to providing a copy of the documents listed above, applicants may demonstrate their right to work by allowing the licensing authority to carry out a check with the Home Office online right to work checking service.

To demonstrate their right to work via the Home Office online right to work checking service, applicants should include in this application their 9-digit share code (provided to them upon accessing the service at <https://www.gov.uk/prove-right-to-work>) which, along with the applicant's date of birth (provided within this application), will allow the licensing authority to carry out the check.

In order to establish the applicant's right to work, the check will need to indicate that the applicant is allowed to work in the United Kingdom and is not subject to a condition preventing them from doing work relating to the carrying on of a licensable activity.

An online check will not be possible in all circumstances because not all applicants will have an immigration status that can be checked online. The Home Office online right to work checking service sets out what information and/or documentation applicants will need in order to access the service. Applicants who are unable to obtain a share code from the service should submit copy documents as set out above.

THE OLD BUTCHERS COFFEE SHOP

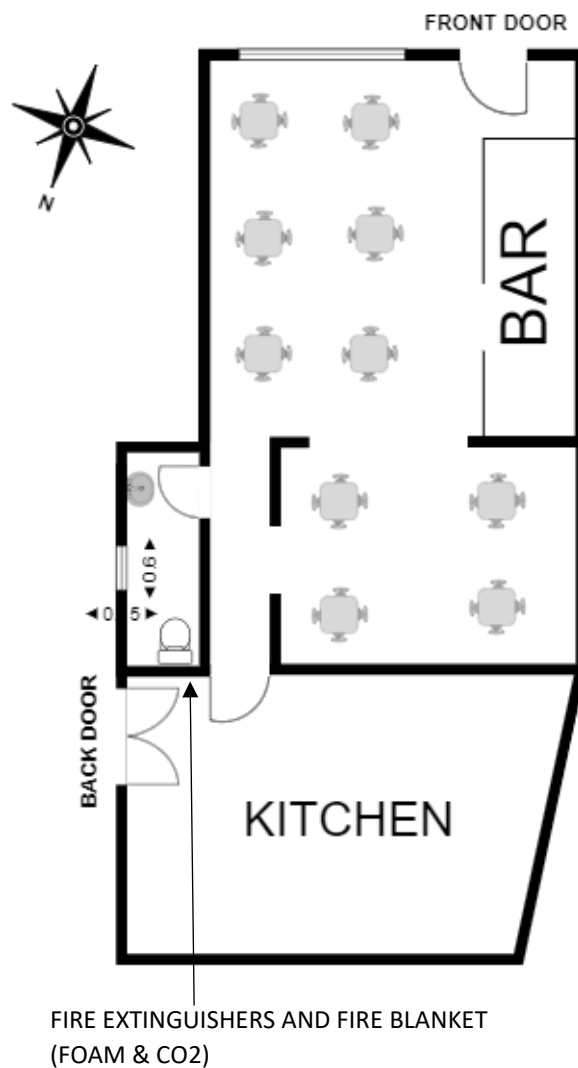

SCALE 1:100 (metric)

Address: 16A York street, Dunnington, York, YO19 5PN

This page is intentionally left blank

Home Office – Guidance Issued Under Section 182 of the Licensing Act 2003

Section 16 Regulated Entertainment

Overview of circumstances in which entertainment activities are not licensable

16.5 There are a number of exemptions that mean that a licence (or other authorisation¹⁸) under the 2003 Act is not required. This Guidance cannot give examples of every eventuality or possible entertainment activity that is not licensable. However, the following activities are examples of entertainment which are not licensable:

- activities which involve participation as acts of worship in a religious context;
- activities in places of public religious worship;
- education – teaching students to perform music or to dance;
- the demonstration of a product – for example, a guitar – in a music shop;
- the rehearsal of a play or performance of music for a private audience where no charge is made with a view to making a profit;
- Morris dancing (or similar)
- Incidental music – the performance of live music or the playing of recorded music if it is incidental to some other activity;
- Incidental film – an exhibition of moving pictures if it is incidental to some other activity;
- A spontaneous performance of music, singing or dancing;
- Garden fetes – or similar if not being promoted or held for purposes of private gain;
- Films for advertisement, information, education or in museums or art galleries;
- Television or radio broadcasts – as long as the programme is live and simultaneous;
- Vehicles in motion – at a time when the vehicle is not permanently or temporarily parked;
- Games played in pubs, youth clubs etc. (e.g. pool, darts and table tennis);
- Stand-up comedy; and
- Provision of entertainment facilities (e.g. dance floors).

16.6 As a result of deregulatory changes that have amended the 2003 Act, no licence is required for the following activities:

- Plays: no licence is required for performances between 08.00 and 23.00 on any day, provided that the audience does not exceed 500.
- Dance: no licence is required for performances between 08.00 and 23.00 on any day, provided that the audience does not exceed 500.
- Films: no licence is required for 'not-for-profit' film exhibition held in community premises between 08.00 and 23.00 on any day provided that the

audience does not exceed 500 and the organiser (a) gets consent to the screening from a person who is responsible for the premises; and (b) ensures that each such screening abides by age classification ratings.

- Indoor sporting events: no licence is required for an event between 08.00 and 23.00 on any day, provided that those present do not exceed 1000.
- Boxing or wrestling entertainment: no licence is required for a contest, exhibition or display of Greco-Roman wrestling, or freestyle wrestling between 08.00 and 23.00 on any day, provided that the audience does not exceed 1000.
- Live music: no licence permission is required for:
 - a performance of unamplified live music between 08.00 and 23.00 on any day, on any premises.
 - a performance of amplified live music between 08.00 and 23.00 on any day on premises authorised to sell alcohol for consumption on those premises, provided that the audience does not exceed 500.
 - a performance of amplified live music between 08.00 and 23.00 on any day, in a workplace²⁶ that does not have a licence, provided that the audience does not exceed 500.
 - a performance of amplified live music between 08.00 and 23.00 on any day, in a church hall, village hall, community hall, or other similar community premises, that is not licensed by a premises licence to sell alcohol, provided that (a) the audience does not exceed 500, and (b) the organiser gets consent for the performance from a person who is responsible for the premises.
 - a performance of amplified live music between 08.00 and 23.00 on any day, at the non-residential premises of (i) a local authority, or (ii) a school, or (iii) a hospital, provided that (a) the audience does not exceed 500, and (b) the organiser gets consent for the performance on the relevant premises from: (i) the local authority concerned, or (ii) the school or (iii) the health care provider for the hospital.
- Recorded Music: no licence permission is required for:
 - any playing of recorded music between 08.00 and 23.00 on any day on premises authorised to sell alcohol for consumption on those premises, provided that the audience does not exceed 500.
 - any playing of recorded music between 08.00 and 23.00 on any day, in a church hall, village hall, community hall, or other similar community premises, that is not licensed by a premises licence to sell alcohol, provided that (a) the audience does not exceed 500, and (b) the organiser gets consent for the performance from a person who is responsible for the premises.
 - any playing of recorded music between 08.00 and 23.00 on any day, at the non- residential premises of (i) a local authority, or (ii) a school, or (iii) a hospital, provided that (a) the audience does not exceed 500, and (b) the organiser gets consent for the performance on the relevant premises from: (i) the local authority concerned, or (ii) the school proprietor or (iii) the health care provider for the hospital.
- Cross activity exemptions: no licence is required between 08.00 and 23.00 on any day, with no limit on audience size for:
 - any entertainment taking place on the premises of the local authority where the entertainment is provided by or on behalf of the local authority;

- any entertainment taking place on the hospital premises of the health care provider where the entertainment is provided by or on behalf of the health care provider;
- any entertainment taking place on the premises of the school where the entertainment is provided by or on behalf of the school proprietor; and
- any entertainment (excluding films and a boxing or wrestling entertainment) taking place at a travelling circus, provided that (a) it takes place within a moveable structure that accommodates the audience, and (b) that the travelling circus has not been located on the same site for more than 28 consecutive days.

- 16.7 The deregulatory changes mean that, for example, an indoor sporting event that takes place between 07.00 and 23.30 on a particular day is licensable in respect of activities taking place between 07.00-08.00 and 23.00-23.30. Similarly, where the audience for a performance of dance fluctuates, those activities are licensable if, and for so long as, the number of people in the audience exceeds 500. If organisers are uncertain as to audience sizes or if audience migration is likely, it might be easier and more flexible to secure an appropriate authorisation. Examples of where a Temporary Event Notice (TEN) could still be required include if the activity is the playing of recorded music or the exhibition of a film that requires an authorisation; or if the entertainment is not authorised by an existing licence or certificate and its conditions.
- 16.8 Of course, anyone involved in the organisation or provision of entertainment activities – whether or not any such activity is licensable under the 2003 Act – must comply with any applicable duties that may be imposed by other legislation relevant to the event (e.g. in areas such as crime and disorder, fire, health and safety, noise, nuisance and planning). Any such person should take steps to be aware of relevant best practice, and may find responsible authorities a useful source of expert support and advice.

This page is intentionally left blank

Annex 3 – Conditions agreed with North Yorkshire Police

1. Documented staff training will be given regarding staff's obligation under the Licensing Act in respect of the:-

- Retail sale of alcohol
- Age verification policy
- Conditions attached to the Premises Licence
- Permitted Licensable activities
- The Licensing objectives and
- The Opening Times of the venue.

Such records shall be kept for a minimum of one year and will be made available immediately upon request from any Responsible Authority.

2. A Refusals Register and Incident Report Register will be kept. Such documents will record incidents of staff refusals of alcohol sales to under-age or drunk people as well as incidents of any anti-social behaviour and ejections from the premises.

Such records shall be kept for at least one year. [For the avoidance of doubt, the one year period relates to each respective entry in the log book and runs from the date of that particular entry]: They will be made available immediately upon a reasonable request from any responsible authority.

3. The premises shall operate the Challenge 25 policy for the sale of alcohol.

The only acceptable proof of age identification shall be a current passport, Photo card Driving Licence or identification carrying the PASS logo (until other Effective identification technology e.g. thumb print or pupil recognition, is adopted by the Premises Licence Holder).

4. The premises shall operate as a coffee house/ bistro not as a bar or vertical drinking establishment providing food and non-alcoholic drinks.
5. There shall be a minimum of 20 chairs/seats for customer use inside the premises at all times the venue is open to reduce the need for vertical drinking
6. All off sales shall be in sealed containers

This page is intentionally left blank

Document is Restricted

This page is intentionally left blank

Annex 5 - Representations

1.

Dear Sir / Madam,

I am writing to object about the Application for a new premises liquor licence at 16A York Street. I have only just noticed the application placed in the menu card by the front door which is not very visible.

We strongly object to the Cafe becoming a licenced premises; it is a residential street, surrounded by residential properties in close proximity which include our young children.

Our property of [REDACTED] York Street is next to the cafe and we would ultimately suffer from disturbed sleep with noise disturbance from people leaving the cafe, particularly after drinking alcohol to the late hour of 11pm as most of the bedrooms are located to the front of the property.

Yours faithfully

[REDACTED]

[REDACTED] York Street
Dunnington
YO19 5PN

[REDACTED]

2.

Dear Sir / Madam,

I have asked my neighbour, Catherine to email on my behalf as my wife and I are in our late 90's and do not use email.

I would like to object to an alcohol licence being granted to the cafe at 16A York Street. My wife and I live opposite the cafe at [REDACTED] York Street and do not wish to be disrupted by people leaving the cafe at a late hour.

Please feel free to call me on: 01904 [REDACTED]

Yours faithfully

[REDACTED]

[REDACTED] York Street
Dunnington

This page is intentionally left blank

Map of area



Date: 20 Jun 2022

Author: City of York Council

Scale: 1:1,250



This page is intentionally left blank

**MANDATORY & PROHIBITED CONDITIONS – PREMISES LICENCE
LICENSING ACT 2003**

MANDATORY CONDITIONS WHERE LICENCE AUTHORISES SUPPLY OF ALCOHOL

1. In accordance with section 19 of the Licensing Act 2003, where a premises licence authorises the supply of alcohol, the licence must include the following conditions.
2. The first condition is that no supply of alcohol may be made under the premises licence -
 - (a) at a time where there is no designated premises supervisor in respect of the premises licence, or
 - (b) at a time when the designated premises supervisor does not hold a personal licence or his personal licence is suspended.
3. The second condition is that every supply of alcohol under the premises licence must be made or authorised by a person who holds a personal licence.
4. (1) The responsible person must ensure that staff on relevant premises do not carry out, arrange or participate in any irresponsible promotions in relation to the premises.
(2) In this paragraph, an irresponsible promotion means any one or more of the following activities, or substantially similar activities, carried on for the purpose of encouraging the sale or supply of alcohol for consumption on the premises –
 - (a) games or other activities which require or encourage, or are designed to require or encourage individuals to –
 - (i) drink a quantity of alcohol within a time limit (other than to drink alcohol sold or supplied on the premises before the cessation of the period in which the responsible person is authorised to sell or supply alcohol), or
 - (ii) drink as much alcohol as possible (whether within a time limit or otherwise);
 - (b) provision of unlimited or unspecified quantities of alcohol free or for a fixed or discounted fee to the public or to a group defined by a particular characteristic in a manner which carries a significant risk of undermining a licensing objective;
 - (c) provision of free or discounted alcohol or any other thing as a prize to encourage or reward the purchase and consumption of alcohol over a period of 24 hours or less in a manner which carries a significant risk of undermining a licensing objective;
 - (d) selling or supplying alcohol in association with promotional posters or flyers on, or in the vicinity of, the premises which can reasonably be considered to condone, encourage or glamorise anti-social behaviour or to refer to the effects of drunkenness in any favourable manner;
 - (e) dispensing alcohol directly by one person into the mouth of another (other than where that other person is unable to drink without assistance by reason of disability).
5. The responsible person must ensure that free potable water is provided on request to customers where it is reasonably available.
6. (1) The premises licence holder or club premises certificate holder must ensure that an age verification policy is adopted in respect of the premises in relation to the sale or supply of alcohol.
(2) The designated premises supervisor in relation to the premises licence must ensure that the supply of alcohol at the premises is carried on in accordance with the age verification policy.

(3) The policy must require individuals who appear to the responsible person to be under 18 years of age (or such older age as may be specified in the policy) to produce on request, before being served alcohol, identification bearing their photograph, date of birth and either –

- (a) a holographic mark, or
- (b) an ultraviolet feature.

7. The responsible person must ensure that –

(a) where any of the following alcoholic drinks is sold or supplied for consumption on the premises (other than alcoholic drinks sold or supplied having been made up in advance ready for sale or supply in a securely closed container) it is available to customers in the following measures –

- (i) beer or cider: ½ pint;
- (ii) gin, rum, vodka or whisky: 25ml or 35ml; and
- (iii) still wine in a glass: 125ml;

(b) these measures are displayed in a menu, price list or other printed material which is available to customers on the premises; and

(c) where a customer does not in relation to a sale of alcohol specify the quantity of alcohol to be sold, the customer is made aware that these measures are available.

MANDATORY CONDITION: ALCOHOL PRICING

1. A relevant person shall ensure that no alcohol is sold or supplied for consumption on or off the premises for a price which is less than the permitted price.

2. For the purposes of the condition set out in paragraph 1 –

(a) “duty” is to be construed in accordance with the Alcoholic Liquor Duties Act 1979(6);

(b) “permitted price” is the price found by applying the formula –

$$P = D + (D \times V)$$

where –

- (i) P is the permitted price,
- (ii) D is the rate of duty chargeable in relation to the alcohol as if the duty were charged on the date of the sale or supply of the alcohol, and
- (iii) V is the rate of value added tax chargeable in relation to the alcohol as if the value added tax were charged on the date of the sale or supply of the alcohol;

(c) “relevant person” means, in relation to premises in respect of which there is in force a premises licence –

- (i) the holder of the premises licence,
- (ii) the designated premises supervisor (if any) in respect of such a licence, or
- (iii) the personal licence holder who makes or authorises a supply of alcohol under such a licence;

(d) “relevant person” means, in relation to premises in respect of which there is in force a club premises certificate, any member or officer of the club present on the premises in a capacity which enables the member or officer to prevent the supply in question; and

(e) “value added tax” means value added tax charged in accordance with the Value Added Tax Act 1994(7).

3. Where the permitted price given by Paragraph (b) of paragraph 2 would (apart from this paragraph) not be a whole number of pennies, the price given by that sub-paragraph shall be taken to be the price actually given by that sub-paragraph rounded up to the nearest penny.

4. (1) Sub-paragraph (2) applies where the permitted price given by Paragraph (b) of paragraph 2 on a day (“the first day”) would be different from the permitted price on the next day (“the second day”) as a result of a change to the rate of duty or value added tax.

(2) The permitted price which would apply on the first day applies to sales or supplies of alcohol which take place before the expiry of the period of 14 days beginning on the second day.

MANDATORY CONDITION: DOOR SUPERVISION

1. In accordance with section 21 of the Licensing Act 2003 (as amended by section 25 Violent Crime Reduction Act 2006), where a premises licence includes a condition that at specified times one or more individuals must be at the premises to carry out a security activity, the licence must include a condition that each such individual must -
 - (a) be authorised to carry out that activity by a licence granted under the Private Security Industry Act 2001; or
 - (b) be entitled to carry out that activity by virtue of section 4 of that Act.
2. But nothing in subsection (1) requires such a condition to be imposed -
 - (a) in respect of premises within paragraph 8(3)(a) of Schedule 2 to the Private Security Industry Act 2001 (c.12) (premises with premises licences authorising plays or films), or
 - (b) in respect of premises in relation to -
 - (i) any occasion mentioned in paragraph 8(3)(b) or (c) of that Schedule (premises being used exclusively by club with club premises certificate, under a temporary event notice authorising plays or films or under a gaming licence, or
 - (ii) any occasion within paragraph 8(3)(d) of that Schedule (occasions prescribed by regulations under that Act).
3. For the purposes of this section -
 - (a) "security activity" means an activity to which paragraph 2(1)(a) of that Schedule applies, and which is licensable conduct for the purposes of that Act (see section 3(2) of that Act), and
 - (b) paragraph 8(5) of that Schedule (interpretation of references to an occasion) applies as it applies in relation to paragraph 8 of that Schedule.

MANDATORY CONDITION: EXHIBITION OF FILMS

1. In accordance with section 20 of the Licensing Act 2003, where a premises licence authorises the exhibition of films, the licence must include a condition requiring the admission of children to the exhibition of any film to be restricted in accordance with this section.
2. Where the film classification body is specified in the licence, unless subsection (3)(b) applies, admission of children must be restricted in accordance with any recommendation made by that body.
3. Where -
 - (a) the film classification body is not specified in the licence, or
 - (b) the relevant licensing authority has notified the holder of the licence that this subsection applies to the film in question, admission of children must be restricted in accordance with any recommendation made by that licensing authority.
4. In this section - 'children' means persons aged under 18; and 'film classification body' means the person or persons designated as the authority under section 4 of the Video Recordings Act 1984 (c.39) (authority to determine suitability of video works for classification).

This page is intentionally left blank

Legislation and Policy Considerations

1. The following provisions of The Licensing Act 2003 apply to this application: S4 general duties of licensing authorities; s17 application for premises licence; s18 determination of application for premises licence; s23 grant or rejection of application; ss19, 20 and 21 mandatory conditions; The Licensing Act (Mandatory Licensing Conditions) Order 2010; and The Licensing Act 2003 (Mandatory Conditions) Order 2014.
2. The following provisions of The Licensing Act 2003 (Premises Licences and Club Premises Certificates) Regulations 2005 apply to this application: Regulation 42, Part 2 (Premises licences) and Part 4 (General) relating to applications, notices and representations and advertisement of applications
3. The following provisions of the Secretary of State's guidance apply to this application: Section 2 The Licensing Objectives; Section 9 Determining applications; Section 10 Conditions attached to premises licences and club certificates; and Section 14 Statements of licensing policy.
4. The following paragraphs of the licensing authority's statement of licensing policy apply to this application: 5.0 Applications for Premises Licences, Club Premises Certificates and Variations; 6.0 Guidelines for Applicants; 7.0 Saturation and Cumulative Impact and 8.0 Licensing Hours.
5. The Committee is reminded of their duty under the Crime and Disorder Act 1998 to consider the crime and disorder implications of their decisions and the authority's responsibility to co-operate in the reduction of crime and disorder in the city.
6. The Committee is reminded that the Human Rights Act 1998 guarantees the right to a fair hearing for all parties in the determination of their civil rights. The Act also provides for the protection of property, which may include licences in existence, and the protection of private and family life.

This page is intentionally left blank